

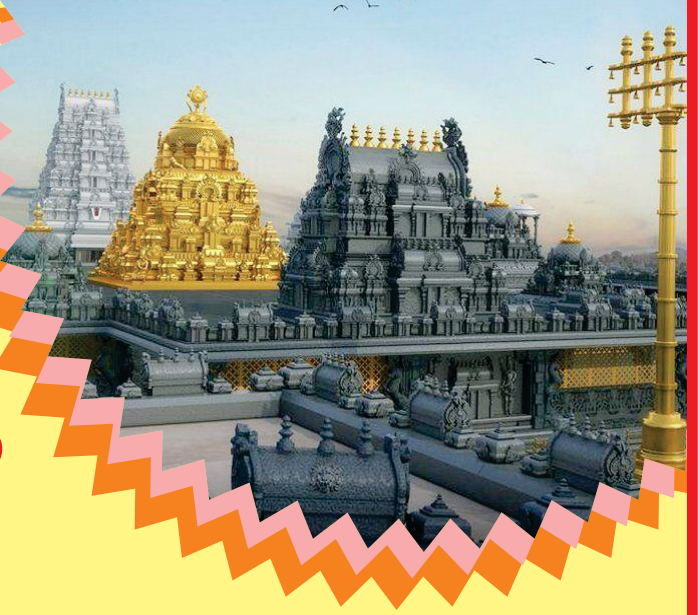

SNS
DEVELOPERS



సమ్మక్క సారక్క ఎవరెస్ట్ ఫామ్స్

@ కొలనుపాక, యాదాద్రి

(తక్కువ పెట్టుబడి, ఎక్కువ భూమి)

శ్రీ చిన్నారల బంగారు భవిష్యత్తుకు

బంగారం కంటే, డిపాజిట్ల కంటే, షేర్ల కంటే లాభదాయకమైన పెట్టుబడి



KOMARAVELLI MALLANNA



JAIN MANDIR



SOMESHWARA TEMPLE



MINI TANK BUND

**ఇంటి స్థలముతో పాటు 6 జామ చెట్లు
తెలివైన పెట్టుబడికి విలువైన రాబడి**

LOCATION HIGHLIGHTS

- * Beside Kotilingala Temple & India's Biggest Jain Mandir Kolanpaka
- * Beside Kolanpaka Mini Tank Bund
- * 5 Min's Drive from Warangal National Highway
- * 5 Min's Drive to Aler Rly. Station & Bus Station
- * 15 Min's Drive to Yadagiri Gutta (Yadadri)
- * Beside Yadadri to Kolanpaka 100Ft Main Road
- * Kolanpaka, Komeravelli, Kesara, Yadagirigutta (Yadadri Tourism Hub)
- * Very near to Komaravelli Mallikarjuna Swamy Temple
- * Very Good Development Area & Fastest Developing Tourism Place

**SPOT
REGISTRATION**

PROJECTS HIGHLIGHTS

- * Clear Title
- * Spot Registration
- * The Entire Layout Designed as Per Vasthu
- * 30 Feet Wide Roads
- * 24 x 7 Security
- * Gate with Fencing
- * Each Plot 6 Guava Trees

PLAN SHOWING THE PROPOSED FARM LAND LAYOUT IN SY NO : 1879 SITUATED AT KOLANPAKA (VILLAGE), ALAIR (MANDAL), YADADRI-BHONGIRI (DISTRICT)

AREA STATEMENT

FARM LAND PLOTTED AREA = 6983 Sq. Yds
 FARM LAND ROAD AREA = 2357 Sq. Yds
 FARM LAND OPEN AREA = 160 Sq. Yds
 FARM LAND LAYOUT AREA = 9480 Sq. Yds

TOTAL AREA
 2 ACRES

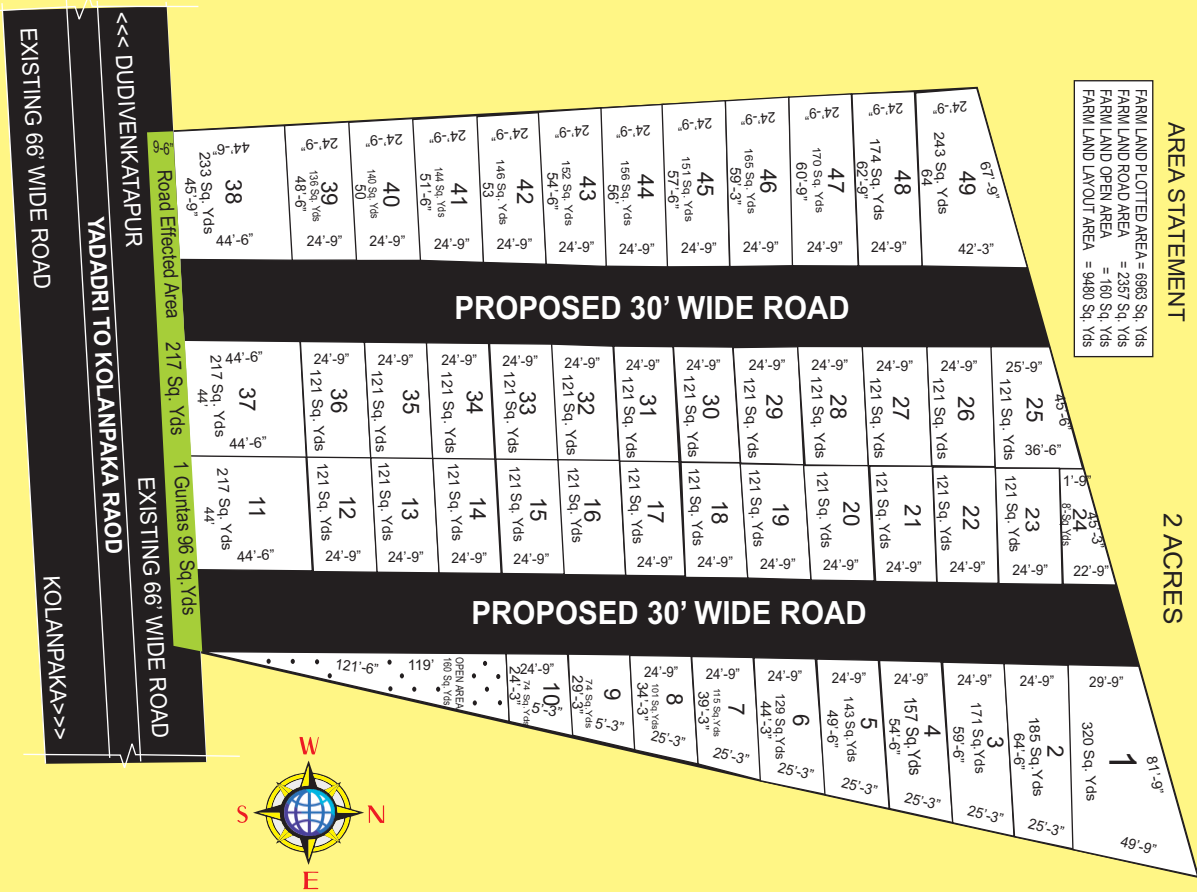

- * Northeast Corner 200 Rupees Extra Per Sq. Yd
- * Extra Other Corner 150 Rupees Extra Per Sq. Yd.
- * East Phase 100 Rupees Extra per Sq. Yd
- * The Cost is directly proportionate according to the size of the plot.
- * Registration charges will be borne by the member

PAYMENT MODE
121 SQ. Yrds (1 Gunta)
 Booking Amount : 10,000/-
 Allotment : 1,00,000/-
 Remaining Balance Should be Paid in 45 Days

SNS DEVELOPERS

Plot No 44, Street No 1A, Mamatha Nagar, Nagole Cross Roads, Beside Supraja Hospital, Nagole, Hyderabad, Telangana 500 068.

For Further Details Contact :

[Blank space for contact details]

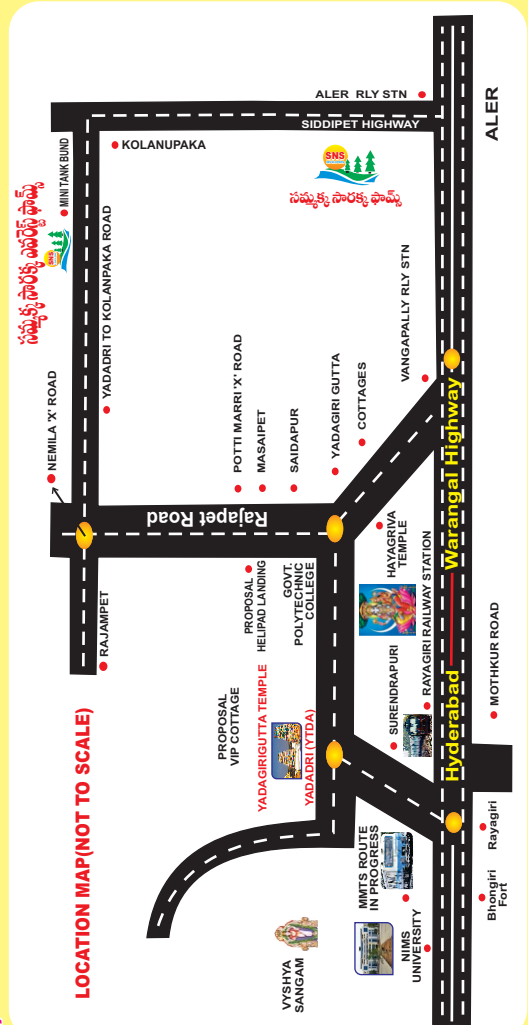

All Credit and debit cards are accepted Cheque / DD's are to be draw in favour of SNS Developers



SNS
DEVELOPERS

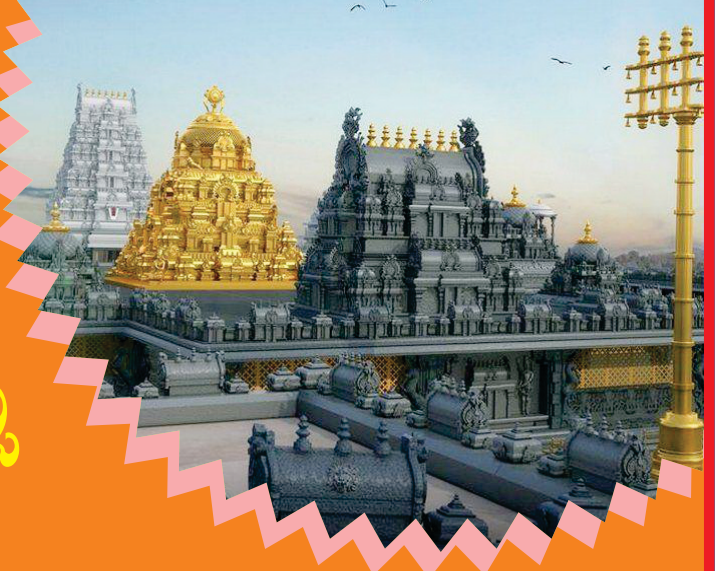

సమ్మక్క సారక్క ఎవరెస్ట్ ఫామ్స్

@ కొలనుపాక, యాదాద్రి
(తక్కువ పెట్టుబడి, ఎక్కువ భూమి)

శ్రీ చిన్నారూల బంగారు భవిష్యత్తుకు
బంగారం కంటే, డిపాజిట్ల కంటే, షేర్ల కంటే లాభదాయకమైన పెట్టుబడి



KOMARAVELLI MALLANNA



JAIN MANDIR



SOMESHWARA TEMPLE

ఇంటి స్థలముతో పాటు 6 జామ చెట్లు
తెలివైన పెట్టుబడికి ఐలువైన రాబడి



MINI TANK BUND



LOCATION HIGHLIGHTS

- * Beside Kotilingala Temple & India's Biggest Jain Mandir Kolanpaka
- * Beside Kolanpaka Mini Tank Bund
- * 5 Min's Drive from Warangal National Highway
- * 5 Min's Drive to Aler Rly. Station & Bus Station
- * 15 Min's Drive to Yadagiri Gutta (Yadadri)
- * Beside Yadadri to Kolanpaka 100Ft Main Road
- * Kolanpaka, Komeravelli, Kesara, Yadagirigutta (Yadadri Tourisam Hub)
- * Very near to Komaravelli Mallikarjuna Swamy Temple
- * Very Good Development Area & Fastest Developing Tourism Place

**SPOT
REGISTRATION**

PROJECTS HIGHLIGHTS

- * Clear Title
- * Spot Registration
- * The Entire Layout Designed as Per Vasthu
- * 30 Feet Wide Roads
- * 24 x 7 Security
- * Gate with Fencing
- * Each Plot 6 Guava Trees

PLAN SHOWING THE PROPOSED FARM LAND LAYOUT IN SY NO : 1879 SITUATED AT KOLANPAKA (VILLAGE), ALAIR (MANDAL), YADADRI-HONGIRI (DISTRICT)

AREA STATEMENT

FARM LAND PLOTTED AREA = 6983 Sq. Yds
 FARM LAND ROAD AREA = 2357 Sq. Yds
 FARM LAND OPEN AREA = 160 Sq. Yds
 FARM LAND LAYOUT AREA = 9480 Sq. Yds

TOTAL AREA
 2 ACRES

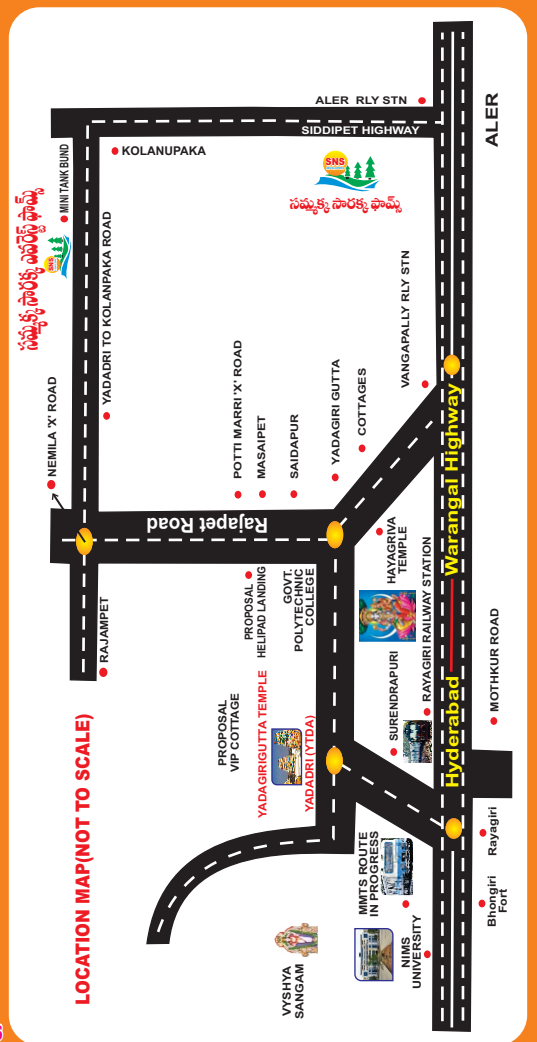
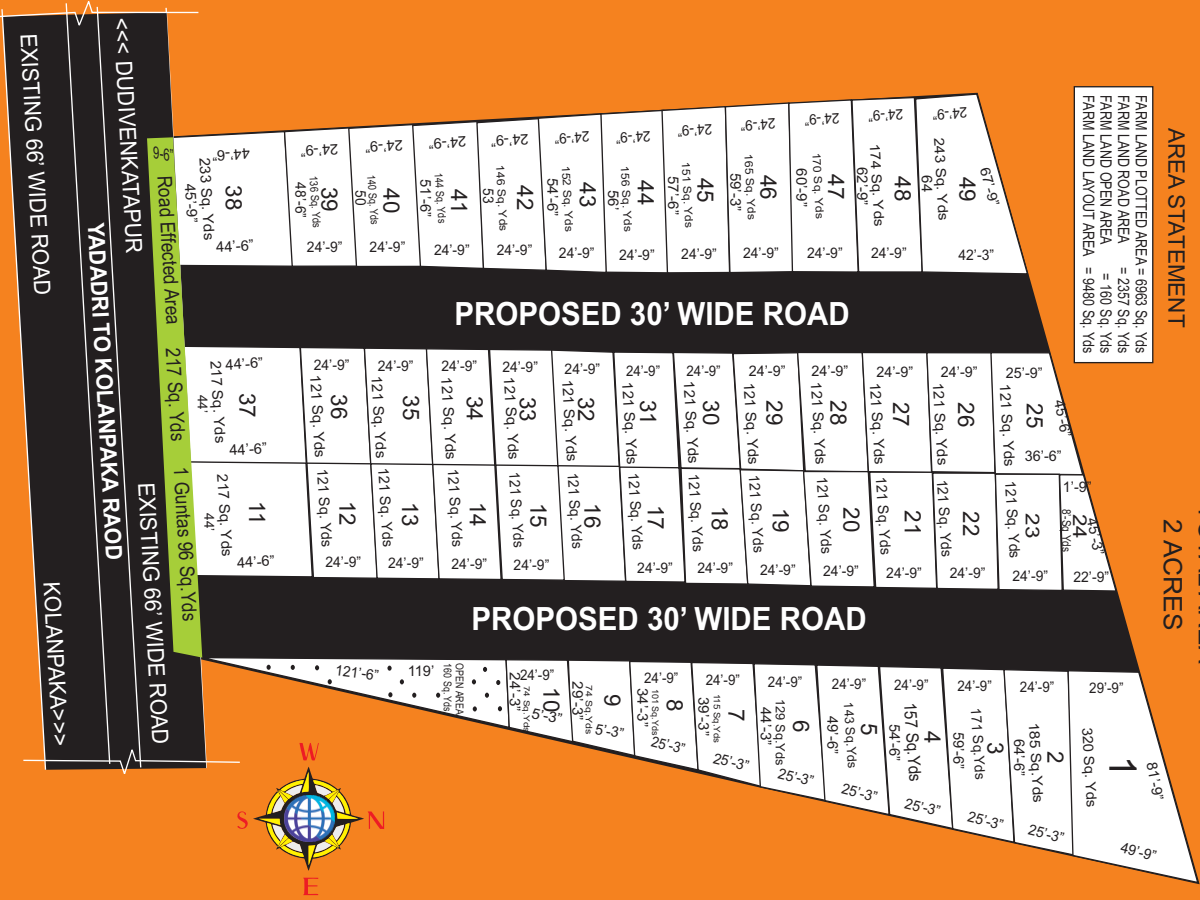

- * Northeast Corner 200 Rupees Extra Per Sq. Yd
- * Extra Other Corner 150 Rupees Extra Per Sq. Yd.
- * East Phase 100 Rupees Extra per Sq. Yd
- * The Cost is directly proportionate according to the size of the plot.
- * Registration charges will be borne by the member

PAYMENT MODE
121 SQ. Yrds (1 Gunta)
 Booking Amount : 10,000/-
 Allotment : 1,00,000/-
 Remaining Balance Should be Paid in 45 Days

SNS DEVELOPERS
 Plot No 44, Street No 1A, Mamatha Nagar, Nagole Cross Roads,
 Beside Supraja Hospital, Nagole, Hyderabad, Telangana 500 068.
 For Further Details Contact :



All Credit and debit cards are accepted Cheque / DD's are to be draw in favour of SNS Developers